

| LOC | | QTY | | REVISIONS | | | | |
|-----|----|-----|-----|--------------------|--------------|----------|------|----|
| CM | 53 | TR | LYR | DESCRIPTION | DATE | OWN | APVD | |
| C | | | | REV & REDWN PER EC | 0L30-0270-97 | 12-11-97 | KW | RS |

AMP LOGO AND CAVITY NUMBER LOCATED THIS SURFACE.

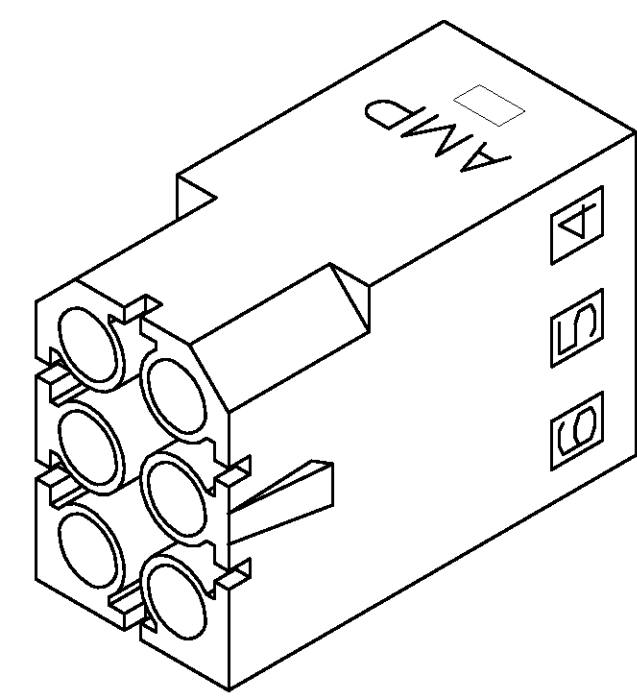
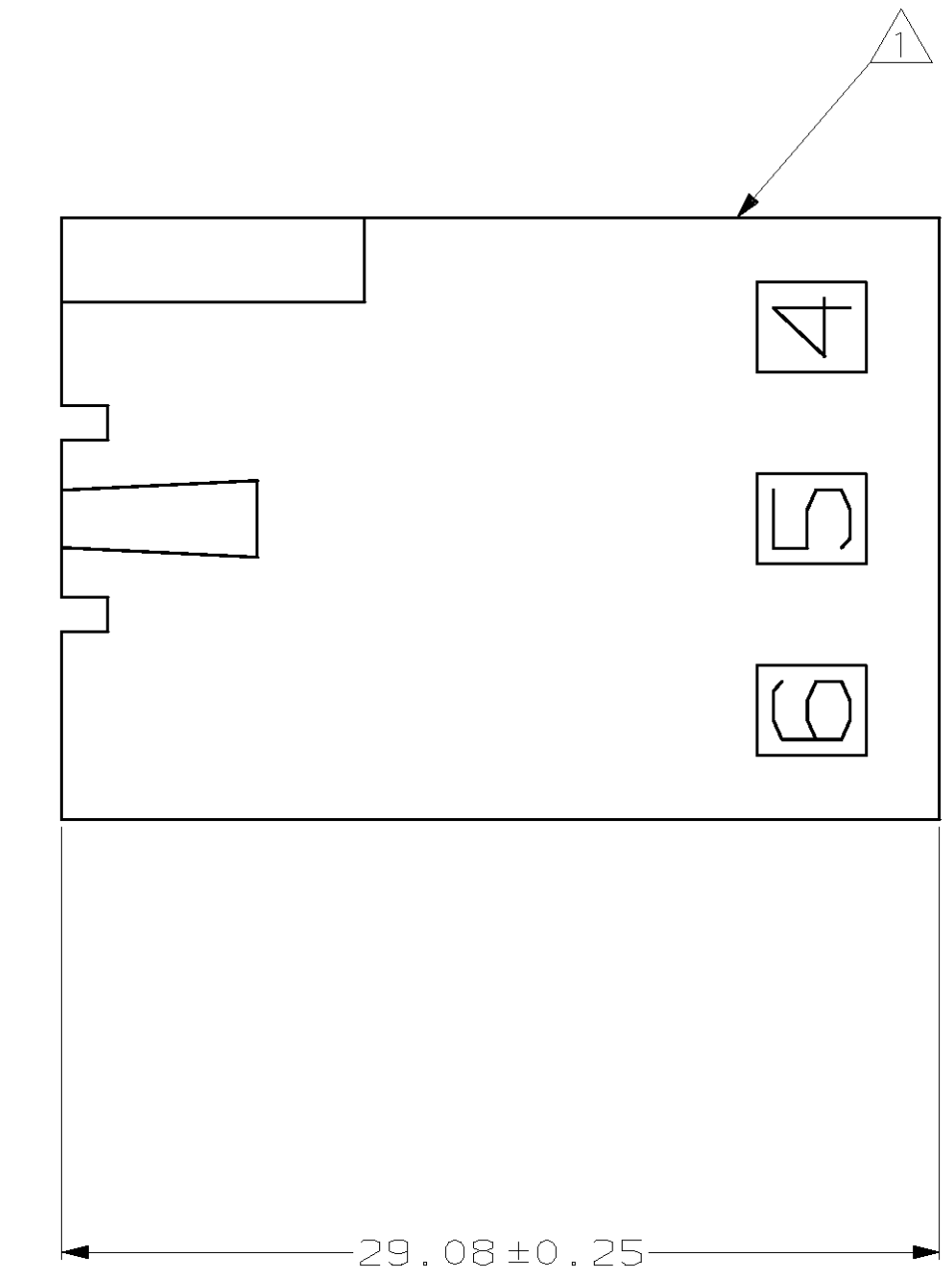
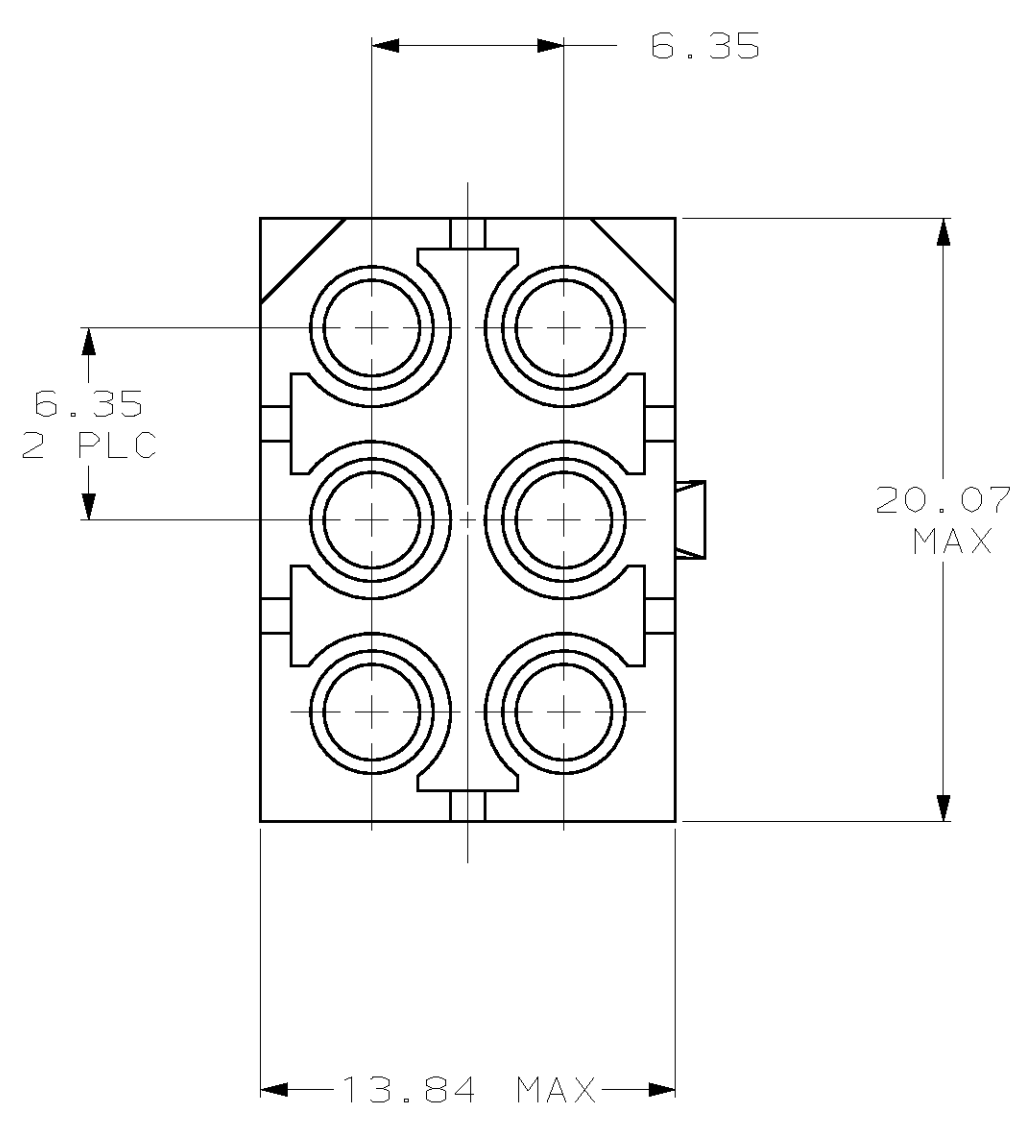
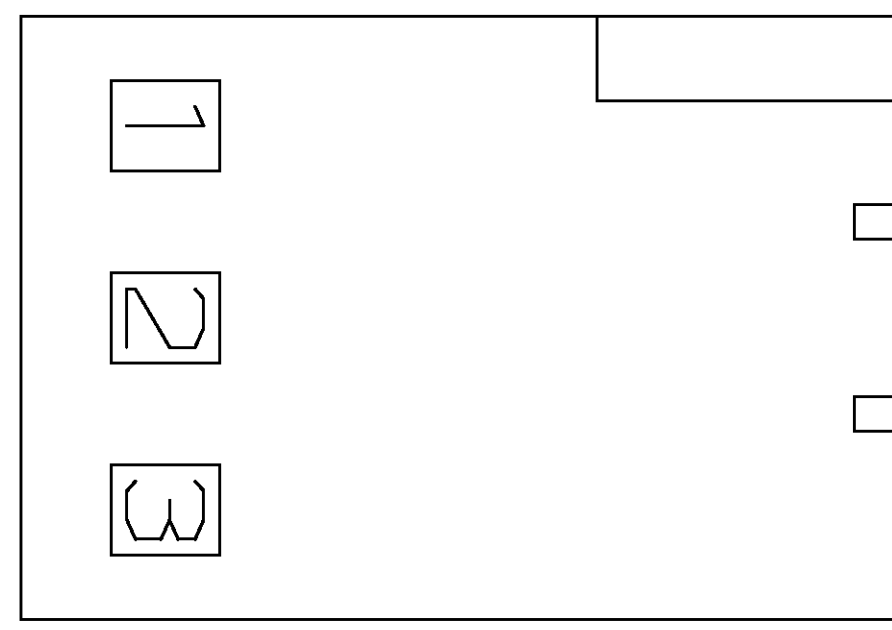

3-DIMENSIONAL MODEL
NTS

| MM | IN |
|-------|-------|
| 29.08 | 1.145 |
| 20.07 | .790 |
| 13.84 | .545 |
| 6.35 | .250 |
| 0.25 | .010 |
| 0.13 | .005 |

CONVERSION TABLE

770360-1
PART NUMBER

METRIC

| | | | |
|--|-----------|---------------------------|--|
| THIS DRAWING IS A CONTROLLED DOCUMENT. | | DWN: K. WHITAKER 12-11-97 | AMP AMP Incorporated Harrisburg, PA 17105-3608 |
| DIMENSIONS: mm | | CHK: R. SWING 12-11-97 | |
| TOLERANCES UNLESS OTHERWISE SPECIFIED: | | APVD: K. CORLE 12-11-97 | NAME: RECEPTACLE, 6 CIRCUIT, .250 PIN AND SOCKET |
| 0 PLC ±- | 1 PLC ±- | PRODUCT SPEC | SIZE: A1 |
| 2 PLC ±0.13 | 3 PLC ±- | APPLICATION SPEC | SCALE: 4:1 |
| 4 PLC ±- | ANGLES ±- | HEIGHT | SHEET 1 OF 1 |
| MATERIAL: NYLON, UL 94V-2, NATURAL | FINISH: - | CUSTOMER DRAWING | REV: C |